

# Schlüter®-KERDI-SHOWER-T / -TT / -TS

## Drainage

Floor-level showers with point drainage

# 8.6

Product data sheet

### Application and function

**Schlüter-KERDI-SHOWER** is a modular system for building floor-level showers with ceramic tiles.

The sloped trays are available in various dimensions for centre and off-centre placement of the matching floor drain system. The associated floor drain system Schlüter-KERDI-DRAIN-BASE can be purchased as a set. Depending on the local conditions of the construction site, other variants of Schlüter-KERDI-DRAIN may be suitable as well. Various sets of the bonded waterproofing membrane Schlüter-KERDI are available for waterproofing the wall areas. The shower trays feature the necessary slope for the drainage points.

The available base dimensions include:

Centre drain:

- 96.5 x 81 cm
- 91.5 x 91.5 cm
- 91.5 x 122 cm
- 101.5 x 101.5 cm
- 122 x 122 cm
- 96.5 x 152.5 cm
- 122 x 152.5 cm
- 122 x 183 cm
- 152.5 x 152.5 cm
- 183 x 183 cm

Off-centre drain:

- 96.5 x 152.5 cm
- 96.5 x 96.5 cm (corner drain, pentagonal)

Smaller dimensions and variations can easily be cut to size with a utility knife. The side ratio and the position of the drainage point must be observed.

The KERDI-DRAIN variants meet a wide range of drainage requirements, including large drain capacity and vertical or horizontal drainage.

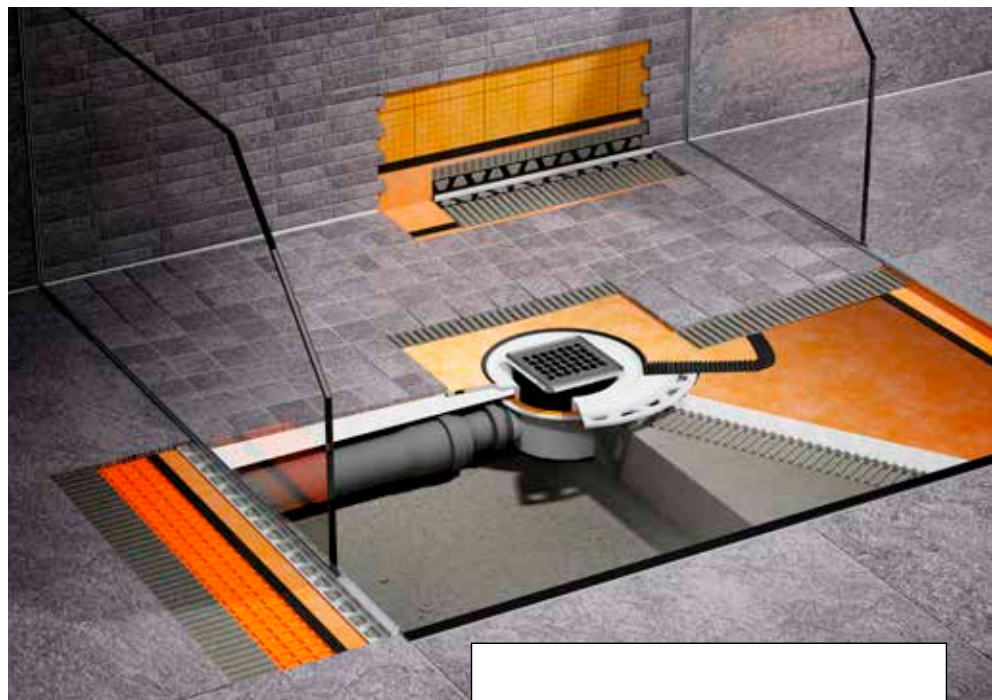

Schlüter-KERDI-SHOWER stands out for its especially reliable and easy installation. Together with the KERDI waterproofing components, this assembly fulfills the national technical approval (abP) required in Germany for bonded waterproofing assemblies with tiles and pavers.

The system components of KERDI-SHOWER are packaged as a set and can be simply combined as necessary.

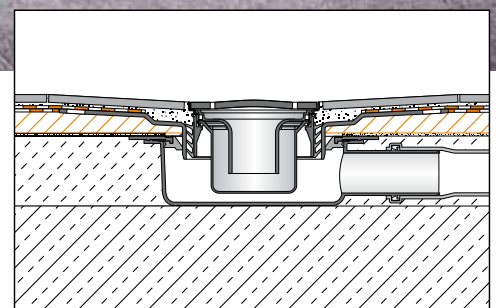

Horizontal drainage

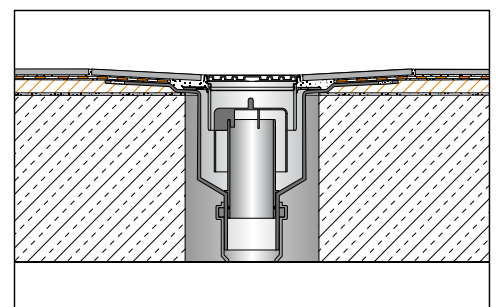

Vertical drainage



## Material

The sloped tray is made of compression-resistant expanded polystyrene (EPS). The drain body is made of high-impact resistant polypropylene (PP).

The bonding flange is made of acrylonitrile butadiene styrene (ABS) and features an attachment flange with a fleece-coated surface.

The pre-adhered Schlüter-KERDI collar on the sloped tray is made of soft polyethylene with a special anchoring fleece laminated on the surface for effectively bonding with tile adhesive or adhesive products for other coverings.

The stainless steel grate included in the waterproofing set Schlüter-KERDI-SHOWER-SKB is made of V2A (material 1.4301 = AISI 304).

## Material properties and areas of application:

The drain body, bonding flange and covers are classified as K3 according to BS EN 1253, Gullies for buildings. The classification K3 refers to areas without vehicle traffic, e.g. wetrooms in apartments, nursing homes, hotels, schools, and public wash-room and shower facilities.

The suitability of a proposed floor drain system must be verified based on the anticipated chemical, mechanical and/or other stresses.

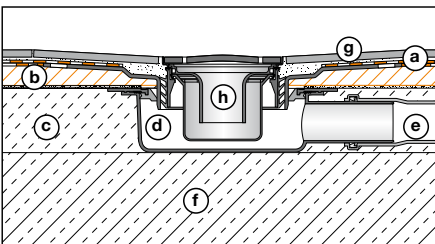

a	Schlüter®-KERDI waterproofing collar
b	Schlüter®-KERDI-SHOWER sloped tray
c	Levelling screed
d	Schlüter®-KERDI-DRAIN-BASE floor drain set
e	Drain pipe
f	Substrate
g	Tiles
h	Grate/frame with height adjustment and integrated odour trap



## Installation

1. Position the drain body on the substrate according to the selected sloped tray and connect it to the existing drainage system, using a drain pipe cut to the appropriate size.

If necessary, use the supplied adapter (DN 40 to DN 50) for connecting. Perform a water tightness test.

2. Properly install the levelling layer (compressive strength  $\geq 0.3 \text{ N/mm}^2$ ) on the load-bearing substrate. Make sure the entire drain body and the drainage pipe are fully encased for complete load transfer. Use the upper edge of the respective floor drain as a levelling guide and make sure it is flush with the upper edge of the levelling layer. If using bound fillings, it may be advisable to apply spackle prior to installing the tray, depending on the condition of the substrate. The respective manufacturer's specifications must be observed.

**Note:** In case of impact sound insulation requirements, the load-transferring levelling layer must be installed over the sound insulation panel Schlüter-KERDI-LINE-SR and sealed with a suitable edge insulation strip along the perimeter.

The maximum compressive strength CP4 ( $\leq 4 \text{ mm}$ ) must be taken into consideration to select a suitable insulation material.

3. The sloped tray is then fully embedded on a sufficiently load-bearing levelling layer, using a dry-setting thin-bed tile adhesive.

Carefully ensure that the abutting joint of the sloped tray does not cover the channel the drainage pipe runs through.

4. Insert the bonding flange into the precisely cut opening of the drain body so that the adhesive flange is flush with the surface of the sloped tray. For embedding, apply thin-bed tile adhesive below the adhesive flange beforehand.
5. To adhere the KERDI collar – which is included in the scope of supply for KERDI-DRAIN – use a 3 x 3 mm or 4 x 4 mm notched trowel to apply KERDI-COLL-L to the bonding flange and the waterproofing collar of the sloped tray to fully embed the KERDI collar. Firmly push the collar in place with the smooth side of the notched trowel or by drawing a smoothing

## 8.6 Schlüter®-KERDI-SHOWER

trowel over the KERDI collar at an angle under pressure. Make sure there are no air bubbles. The curing time of the adhesive must be observed.

- Fully embed the waterproofing membrane KERDI 200 for waterproofing the wall areas. Adhere the sealing band KERDI-KEBA and pre-fabricated Schlüter-KERECK corner pieces to the abutting membrane joints in the installation area as well as along the wall/floor transitions with KERDI-COLL-L. Use the matching KERDI pipe collars for waterproofing pipe penetrations. Further instructions can be found in the corresponding product data sheets, 8.1 Schlüter-KERDI and 8.4 Schlüter-KERDI-COLL-L.

### Note:

If the wall areas are covered with Schlüter-KERDI-BOARD, the same material can be used for waterproofing the walls (see product data sheet 12.1 Schlüter-KERDI-BOARD). Adhere KERDI-KEBA and KERDI-KERECK with KERDI-COLL-L to abutting joints and corner areas for waterproofing.

- Tiles can be installed using the thin-bed method as soon the bonded waterproofing has been completed as described above. No curing time is required.
- To install the tiles, apply the dry setting thin-bed tile adhesive directly on the KERDI collar and then fully embed the tiles in the adhesive. The floor area can withstand normal foot traffic, regardless of the tile dimensions. An additional load distribution layer or larger tile formats should be installed if higher traffic loads, e.g. from wheelchair use, are expected.

### Note:

System-certified tile adhesives must be used in areas that require assemblies according to abP (certificate of technical approval) or CE-compliance. Please contact us at the address listed in this data sheet for further information about such products.

As part of installing the floor tiles, insert the housing of the drain grate and the integrated odour trap into the bonding flange and align it flush with the surface in accordance with the tile thickness. Place tile adhesive underneath the grate frame.

- Other coverings such as coatings, vinyl and similar materials can be installed in principle, but are not described in further detail here and require additional clarification. Please contact us for our recommendations.

The trays already feature the necessary slope for the drainage points. They are precisely customised to accommodate the KERDI-DRAIN bonding flange with adhesive flange.

Depending on the construction situation, the sloped tray can be installed on the corresponding load-bearing substrates (e.g. wooden floors, vertical drain, mortar substrate etc.).

The KERDI collar is pre-adhered to the sloped trays. For easier handling, the sloped trays are shipped in a folded format.

The sloped trays KERDI-SHOWER-KST 1525 and -KST 1830 comprise 2 parts, which can be connected to form a flush dovetail design. The connecting joint is sealed with KERDI-KEBA and KERDI-COLL-L.

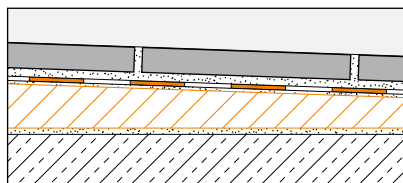

Schlüter®-KERDI-SHOWER-T

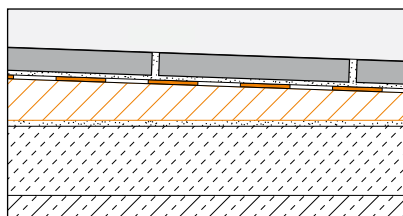

Schlüter®-KERDI-SHOWER on levelling screed

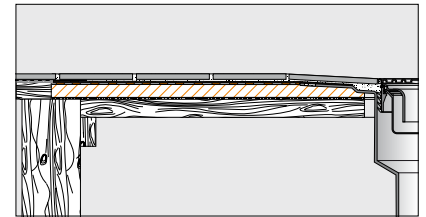

Sample installation of Schlüter®-KERDI-SHOWER-TT

### Schlüter®-KERDI-SHOWER-T

Sloped tray with centre drainage point and pre-adhered waterproofing collar.

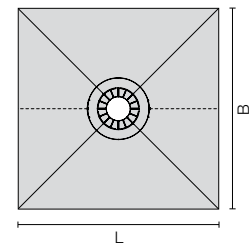

### Schlüter®-KERDI-SHOWER-TT

Sloped tray with centre or off-centre drainage point and pre-adhered waterproofing collar.

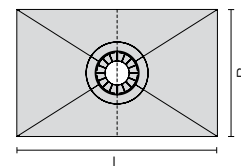
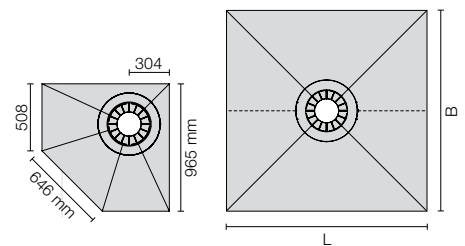

### Schlüter®-KERDI-SHOWER-TS



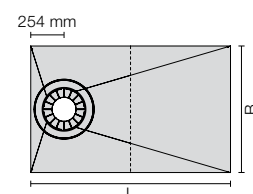

Sloped tray with off-centre drainage point and pre-adhered waterproofing collar.



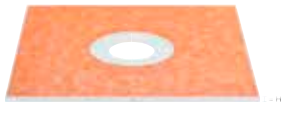

## Product overview:

### Dimensions of Schlüter-KERDI-SHOWER boards

KERDI-SHOWER-T					
	Art.-No.	B (cm)	L (cm)	H max. (mm)	Information
	KST965/1525	96.5	152.5	29	<ul style="list-style-type: none"> <li>• Centre drainage</li> <li>• 2% slope</li> </ul>
	KST1220/1525	122	152.5	28	
	KST1220/1830	122	183	32	
	KST1525	152.5	152.5	30	<ul style="list-style-type: none"> <li>• Two-part sloped tray</li> <li>• Centre drainage</li> <li>• 2% slope</li> </ul>
	KST1830	183	183	32	
KERDI-SHOWER-TT					
	Art.-No.	B (cm)	L (cm)	H max. (mm)	Information
	KST965NA/BF	96.5	96.5	26	<ul style="list-style-type: none"> <li>• Off-centre drainage</li> <li>Distance to long sides: 30.4 cm</li> <li>• 2% slope</li> </ul>
	KST965/810BF	81	96.5	23	<ul style="list-style-type: none"> <li>• Centre drainage</li> <li>• 2% slope</li> </ul>
	KST915BF	91.5	91.5	22	
	KST915/1220BF	91.5	122	25	
	KST1015BF	101.5	101.5	23	<ul style="list-style-type: none"> <li>• Centre drainage</li> <li>• 2% slope</li> </ul>
	KST1220BF	122	122	25	
KERDI-SHOWER-TS					
	Art.-No.	B	L	Height max.	Information
	KST965/1525S	96.5	152.5	28	<ul style="list-style-type: none"> <li>• Off-centre drainage</li> <li>Distance to short side: 25.4 cm</li> <li>• 1% slope on length;</li> <li>• 3% slope on width</li> </ul>



### Schlüter-KERDI-SHOWER-SK

is a waterproofing set for floor-level showers. Schlüter-KERDI-SHOWER-SK includes Schlüter-KERDI (1) for waterproofing the wall areas of showers as well as the corresponding pre-fabricated parts for internal corners (2) and pipe collars (3). The scope of supply also includes the Schlüter-KERDI-KEBA sealing band (4) for waterproofing the abutting joints of membranes and floor-wall transitions and Schlüter-KERDI-COLL-L sealing adhesive (6). Schlüter-KERDI-SHOWER-SK is suitable for conventional floor-level showers created with screed.

### Schlüter-KERDI-SHOWER-SKB

also comes with a Schlüter-KERDI-DRAIN-BASE floor drain. Schlüter-KERDI-SHOWER-SKB is equally suitable for conventional floor-level showers.

#### Note:

\*\*\* Schlüter-KERDI-DRAIN-BASE is only included in the waterproofing set Schlüter-KERDI-SHOWER-SKB.

Art.-No. KSS 5 or KSS5 KD 10 EH 40\* = waterproofing set up to 1000 x 1000 mm

Art.-No. KSS 10 or KSS 10 KD 10 EH 40\*\* = waterproofing set up to 2000 x 2000 mm or 900 x 1800 mm



**Schlüter®-KERDI 200**  
(1 m x 5 m\*) / (1 m x 10 m\*\*)



**Schlüter®-KERDI-KERECK/FI**  
(2 pcs.)

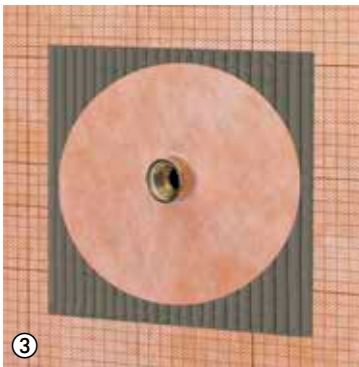

**Schlüter®-KERDI-KM**  
(2 pcs.)



**Schlüter®-KERDI-KEBA**  
(12.5 cm x 10 m)

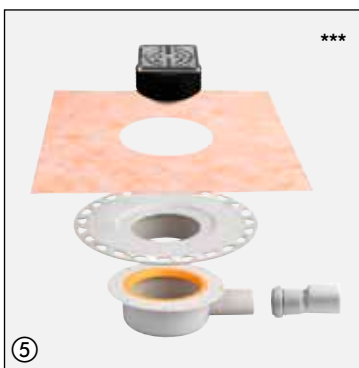

**Schlüter®-KERDI-DRAIN-BASE**  
(1 piece)  
incl. grate and frame set



**Schlüter®-KERDI-COLL-L**  
(1.85 kg\*) / (4.25 kg\*\*)

**Text template for tenders:**

\_\_\_\_\_ Schlüter-KERDI-SHOWER-T / -TT / TS as a floor-level shower tray component suitable for tiling and wheelchair use, made of rigid expanded polystyrene foam, with Schlüter-KERDI laminated on the surface and featuring a centre drain, in size:

- 96.5 x 81 cm
- 91.5 x 91.5 cm
- 91.5 x 122 cm
- 101.5 x 101.5 cm
- 122 x 122 cm
- 96.5 x 152.5 cm
- 122 x 152.5 cm
- 122 x 183 cm
- 152.5 x 152.5 cm
- 183 x 183 cm

with off-centre drain in size:

- 96.5 x 152.5 cm
- 96.5 x 96.5 cm (corner drain, pentagonal), ... to be supplied and professionally installed according to manufacturer's specifications.

Art.-No. \_\_\_\_\_  
Material: \_\_\_\_\_ £/unit  
Labour: \_\_\_\_\_ £/unit  
Total: \_\_\_\_\_ £/unit

**Text template for tenders:**

\_\_\_\_\_ units Schlüter-KERDI-SHOWER-SK bonded waterproofing set, comprising Schlüter-KERDI as a crack bridging polyethylene waterproofing membrane with anchoring fleece laminated on both sides for bonding with the tile adhesive, Schlüter-KERDI-KEBA as a sealing band made of polyethylene membrane with anchoring fleece laminated on both sides for waterproofing abutting joints and floor/wall transitions, 2 pcs. Schlüter-KERDI-KERECK as pre-fabricated internal corners made of polyethylene membrane with anchoring fleece laminated on both sides for waterproofing corner areas, 2 pcs. Schlüter-KERDI-KM as a polyethylene pipe collar with a 22 mm cut-out and anchoring fleece laminated on both sides, 1 pc. Schlüter-KERDI-COLL-L as a two-component sealing adhesive consisting of a solvent-free acrylate dispersion and a reactive cementitious powder for bonding and sealing overlapping Schlüter-KERDI membranes

- for floor-level showers up to 1.0 m x 1.0 m
  - for floor-level showers up to 2.0 m x 2.0 m
- ... to be supplied and professionally installed according to manufacturer's specifications.

Art.-No. \_\_\_\_\_  
Material: \_\_\_\_\_ £/unit  
Labour: \_\_\_\_\_ £/unit  
Total: \_\_\_\_\_ £/unit

**Text template for tenders:**

\_\_\_\_\_ units Schlüter-KERDI-SHOWER-SKB bonded waterproofing set incl. floor drain, comprising Schlüter-KERDI as a crack bridging polyethylene waterproofing membrane with anchoring fleece laminated on both sides, Schlüter-KERDI-KEBA as a sealing band of polyethylene membrane with anchoring fleece laminated on both sides for waterproofing abutting joints and floor/wall transitions, 2 pcs. Schlüter-KERDI-KERECK as pre-fabricated internal corners made of polyethylene membrane with anchoring fleece laminated on both sides for waterproofing corner areas, 2 pcs. Schlüter-KERDI-KM as a polyethylene pipe collar with a 22 mm cut-out and anchoring fleece laminated on both sides, 1 pc. Schlüter-KERDI-COLL-L as a two-component sealant adhesive consisting of a solvent free acrylate dispersion and a reactive cementitious powder for bonding and sealing overlapping Schlüter-KERDI membranes,

- 1 pc. Schlüter-KERDI-DRAIN-BASE as a floor drain with odour trap, horizontal drain outlet DN 40/DN 50 (40/50 mm), and bonding flange with a 10 x 10 cm stainless steel grate (Design 1)

- for floor-level showers up to 1.0 m x 1.0 m
  - for floor-level showers up to 2.0 m x 2.0 m
- ... to be supplied and professionally installed according to manufacturer's specifications.

Art.-No. \_\_\_\_\_  
Material: \_\_\_\_\_ £/unit  
Labour: \_\_\_\_\_ £/unit  
Total: \_\_\_\_\_ £/unit