

Schlüter® -DILEX-EKE/-EF

Corner profile

for flexible corner and perimeter joints

4.13

Product data sheet

Application and function

Schlüter-DILEX-EKE and **-EF** are single-part corner profiles for internal wall corners. If the floor covering is not constructed as a floating screed, DILEX-EKE and -EF may also be used as flexible floor/wall transitions. The trapezoid perforated, lateral anchoring legs are firmly embedded in the adhesive below the tile covering. In the case of DILEX-EKE, one of the anchoring legs forms a chamber for inserting cut tile edges.

In the case of DILEX-EF, the tiles abut the profile from both sides, leaving a uniform joint space. The tile surface can be either flush with the profile edge or up to approx. 2 mm lower, which allows for choosing a variety of tile thicknesses. Completely fill the joint between the profile and the tiles with grout (or partly with tile adhesive during installation).

The visible movement zone is only 5 mm wide. It must be verified for individual projects whether this 5 mm zone is sufficient for the anticipated movements.

Material

Schlüter-DILEX-EKE and -EF consist of recycled rigid PVC anchoring legs and a movement zone made of soft CPE.

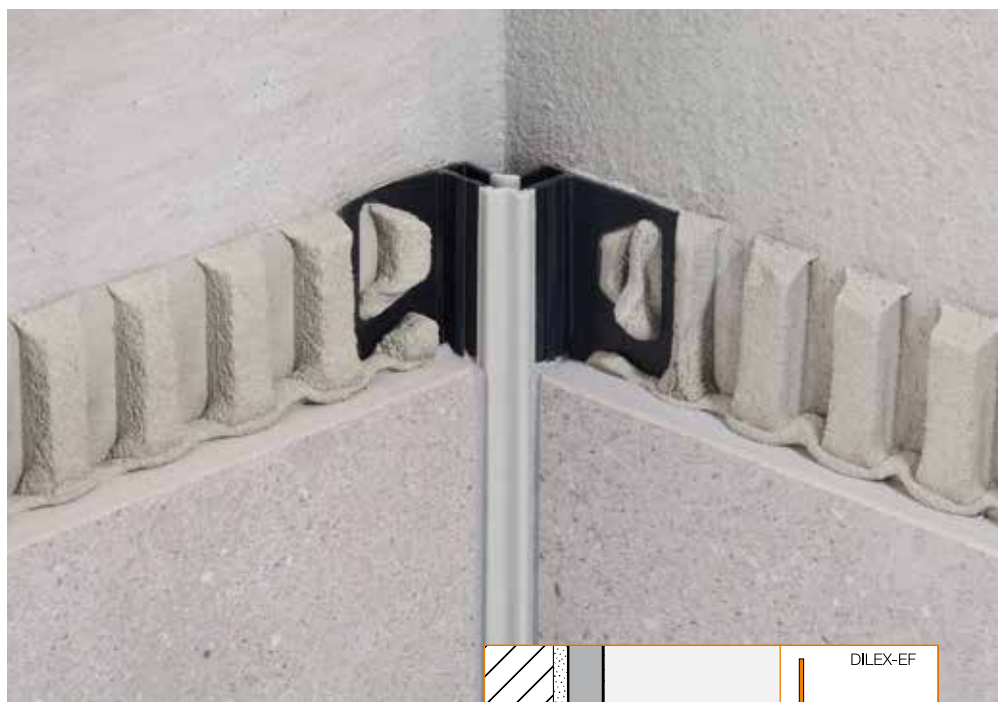

Material properties and areas of application:

Schlüter-DILEX-EKE and -EF are installed as corner movement profiles for floor/wall transitions and internal wall corners. The material is resistant to the chemical stresses that are typically associated with tile coverings. The CPE movement zone is UV resistant and can withstand exposure to weather. It is also resistant to fungi and bacteria and is therefore suitable for use in areas with food contact. The CPE material is resistant to a number of acids, alkalis, oils, lubricants and solvents. In special cases, the suitability of a profile type must be verified based on the anticipated chemical, mechanical and/or other stresses.

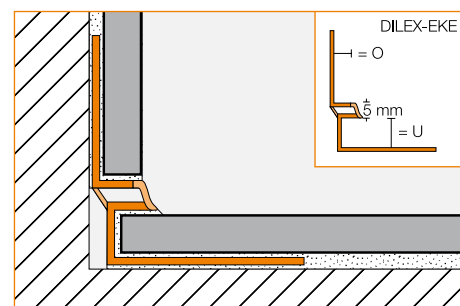
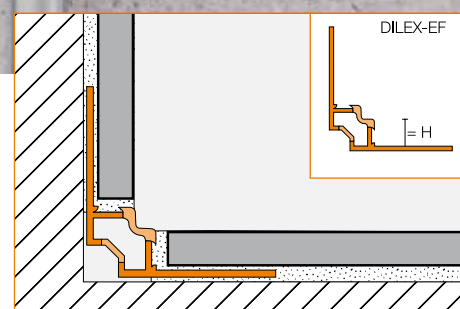



Installation of Schlüter®-DILEX-EKE

1. Select Schlüter-DILEX-EKE according to the tile thickness. The profile height "U" must be sufficient to enable insertion of the tile into the chamber (e.g. U 11 for a tile thickness of approx. 8–10 mm).
2. Embed the trapezoid perforated anchoring legs, firmly press the profile into the adhesive and trowel mortar over the profile legs.
3. Install the tiles on one side, leaving a joint of approx. 2 mm between the tiles and the profile. Insert the cut edge of the tile into the profile chamber on the other side, using a sufficient amount of adhesive to completely fill the space between the rear wall of the chamber and the tile.
4. Completely fill the space between the profile and the tile with grout.

Installation of Schlüter®-DILEX-EF

1. Select Schlüter-DILEX-EF according to the tile thickness to ensure that the tile surface is either flush with the profile edge or up to approx. 2 mm lower.
2. Embed the trapezoid perforated anchoring legs, firmly press the profile into the adhesive and trowel mortar over the profile legs.
3. Leave a gap of approx. 2 mm between the tiles and the profile.
4. Completely fill the space between the profile and the tile with grout.

Notes

Schlüter-DILEX-EKE and -EF are resistant to fungi and bacteria, and require no special maintenance or care. They can be cleaned with regular household detergents when cleaning the tile covering.

Text template for tenders:

_____ linear metres of Schlüter-DILEX-EKE as a corner movement profile for floor/wall connections and internal wall corners with lateral trapezoid perforated anchoring legs made of rigid PVC and an insertion channel for cut tile edges, connected by an approx. 5 mm flexible movement zone made of soft CPE, to be supplied and professionally installed. The installation instructions of the manufacturer must be observed.
 Profile height U: _____ mm
 Profile height O: _____ mm
 Colour: _____
 Art.-No.: _____
 Material: _____/m
 Labour: _____/m
 Total: _____/m

Text template for tenders:

_____ linear metres of Schlüter-DILEX-EF as a single-piece corner movement profile for floor/wall transitions and internal wall corners with lateral, trapezoid perforated anchoring legs of rigid PVC, flexibly connected with an approx. 5 mm cove-shaped movement zone made of soft CPE, to be supplied and professionally installed. The installation instructions of the manufacturer must be observed.
 Profile height: _____ mm
 Colour: _____
 Art.-No.: _____
 Material: _____/m
 Labour: _____/m
 Total: _____/m

Product overview:

Schlüter®-DILEX-EKE

Colours: G = grey, PG = pastel grey, BW = brilliant white, HB = light beige, GS = graphite black, SP = soft peach
 Supplied length: 2.50 m

Colours	G	PG	BW	HB	GS	SP
U = 8 mm / O = 7 mm	•	•	•	•	•	•
U = 9 mm / O = 8 mm	•	•	•	•	•	•
U = 11 mm / O = 10 mm	•	•	•	•	•	•
U = 13 mm / O = 12 mm	•	•	•	•	•	•
U = 15 mm / O = 14 mm	•	•	•	•	•	•

Schlüter®-DILEX-EF

Colours: G = grey, PG = pastel grey, BW = brilliant white, HB = light beige, SP = soft peach
 Supplied length: 2.50 m

Colours	G	PG	BW	HB	SP
H = 8 mm	•	•	•	•	•
H = 10 mm	•	•	•	•	•
H = 12,5 mm	•	•	•	•	•
H = 15 mm	•	•	•	•	•

