

Schlüter®-DILEX-HKS / -EHK

Coved movement joint profile
manufactured from stainless steel

4.15

Product data sheet

Application and Function

Schlüter®-DILEX-EHK is a cove shaped stainless steel profile for facilitating the maintenance of internal corners of ceramic or natural stone wall surfaces where stringent hygienic requirements must be met and where limited movement is expected.

Schlüter®-DILEX-HKS, like Schlüter®-DILEX-EHK, is a cove shaped stainless steel profile, which also features a maintenance free movement zone to absorb movements at floor to wall transitions and at internal wall corners.

The profiles are especially suitable for hospitals, industrial kitchens, clean rooms, washrooms and food processing plants and where aesthetic appeal is desired. Accessories for both Schlüter®-DILEX-EHK and Schlüter®-DILEX-HKS include internal and external corners and connectors.

Material

The profiles are available in the following material versions:

E = stainless steel

V2A, material no. 1.4301 = AISI 304

V4A material no. 1.4404 = AISI 316L

EB = brushed stainless steel

(DILEX-EHK only)

They are made of stainless steel produced in a rollforming process and feature trapezoid perforations on the anchoring legs.

The movement zone of Schlüter®-DILEX-HKS consists of an 11 mm wide, highly flexible synthetic rubber insert.



Material properties and areas of application

In special cases, the suitability of the intended profile types must be verified based on the anticipated chemical and mechanical stresses. The information provided below is intended as a general guideline. The support profiles Schlüter®-DILEX-HKS and Schlüter®-DILEX-EHK are made of stainless steel V2A (material no. 1.4301 = AISI 304) or V4A (material no. 1.4404 = AISI 316L) and are particularly well suited for applications that, in addition to heavy mechanical stresses, require resistance to chemicals such as acidic or alkaline media or detergents.

The use of V4A is recommended if consistent exposure is expected, for example in the case of swimming pools (fresh water). Even stainless steel is not resistant to all chemical

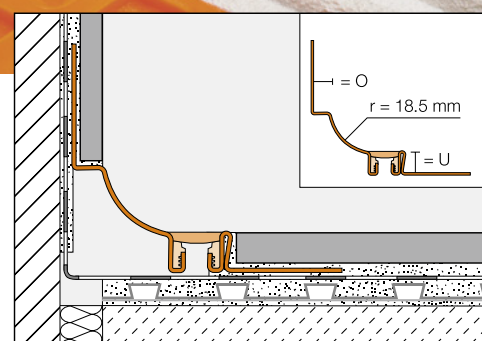



stresses and may be affected by hydrochloric and hydrofluoric acid or certain chloride and brine concentrations. Consideration of anticipated chemical stresses should therefore be verified in advance. Depending on the anticipated chemical stresses, customers can choose between the alloy materials 1.4301 (V2A) or 1.4404 (V4A). The flexible movement zone of Schlüter®-DILEX-HKS is made of soft synthetic rubber. This rubber is resistant to most chemicals encountered in tiled or natural stone environments. It is also resistant to fungi and bacteria. The insert is resistant to temperatures ranging from -60 °C to 100 °C. The synthetic rubber can be heat bonded to extend the profile length.

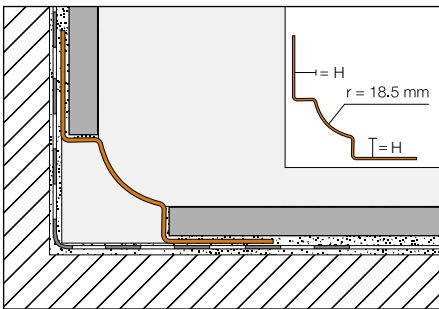
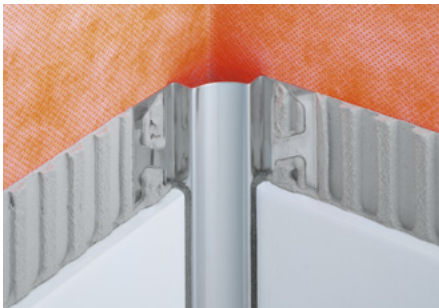

Schlüter®-DILEX-EHK

Installation

1. Select Schlüter®-DILEX-HKS or Schlüter®-DILEX-EHK according to the tile thickness.
2. Apply tile adhesive to the area where the profile is to be installed, using a notched trowel.
3. Press the trapezoid perforated anchoring legs of Schlüter®-DILEX-HKS or Schlüter®-DILEX-EHK securely into the adhesive and align.
4. Place additional adhesive over the trapezoid perforated anchoring leg to ensure full coverage. Trowel tile adhesive against the vertical anchoring leg at an angle.
5. Profile joints and internal and external corners are covered with the appropriate special pieces and adhered using a permanently elastic, waterproof adhesive. Prior to the application, any substances which may inhibit bonding, such as grease, etc have to be removed. The special pieces should overlap the profiles by at least 10 mm.
6. The tiles adjoining the profile must be solidly embedded into the adhesive bed.
7. A joint of approximately 2 mm should be left between the tile and the profile. Fill the joint completely with grout.

Maintenance

Schlüter®-DILEX-EHK and Schlüter®-DILEX-HKS require no special maintenance or care. Clean profiles using common household cleaning agents. To obtain a bright finish on the exposed surface of the profile, use a chrome polishing agent or similar.

The movement zone of Schlüter®-DILEX-HKS is specially treated to resist the growth of fungi and bacteria and requires no special maintenance or care. The flexible movement zone of synthetic rubber is easily exchangeable.

Stainless steel surfaces exposed to the environment or aggressive substances should be cleaned periodically using a mild household cleaner. Regular cleaning maintains the neat appearance of stainless steel and reduces the risk of corrosion. All cleaning agents must be free of hydrochloric and hydrofluoric acid.

We recommend the use of the stainless steel cleaning polish Schlüter®-CLEAN-CP.



Illustration 1: Internal Corner

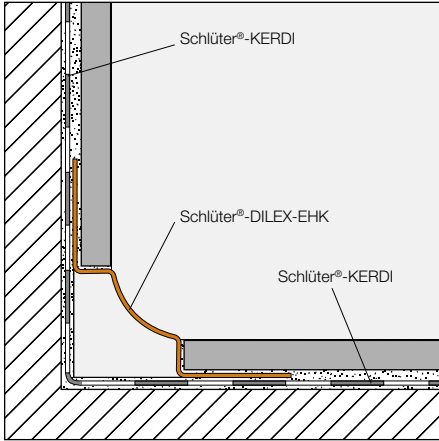

Illustration 2: Internal Corner

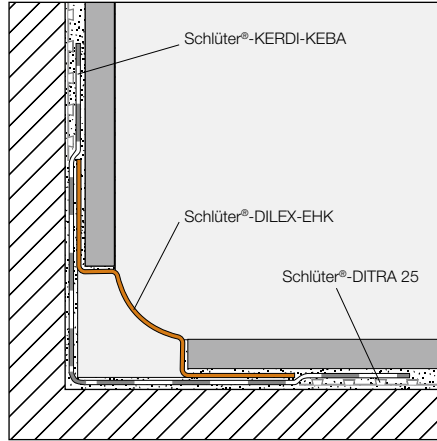

Illustration 3: Floor to Wall Transition

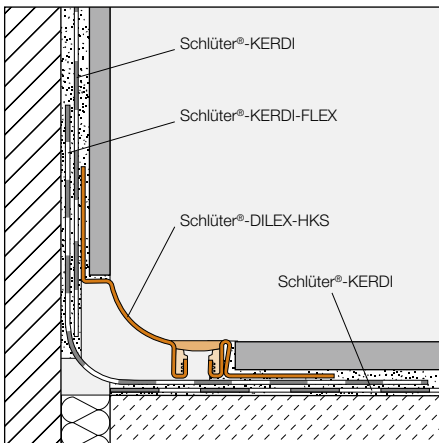
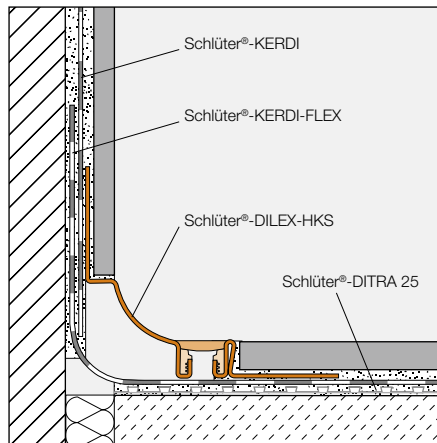
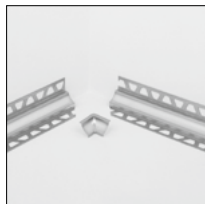

Illustration 4: Floor to Wall Transition



External corner



Internal corner I2 (2 way)

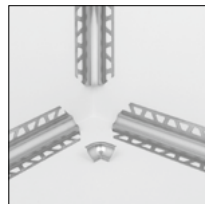

Internal corner I3 (3 way)

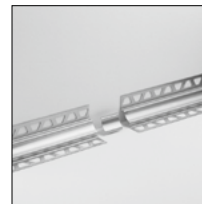

Connector

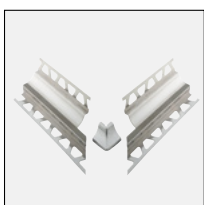

Corner set for Schlüter®-DILEX-HKS



Product Overview

Schlüter®-DILEX-HKS

E = stainless steel,

EV4A = stainless steel 1.4404 (V4A)

Length supplied: 2.50 m

Material	E	EV4A
U 8 / O 7	•	•
U 10 / O 7	•	•
U 12 / O 7	•	•
U 14 / O 7	•	•
U 16 / O 7	•	•
U 18 / O 7	•	
U 21 / O 7	•	
U 25 / O 7	•	
U 30 / O 7	•	

U = mm / O = mm

Material	E	EV4A
U 8 / O 9	•	•
U 10 / O 9	•	•
U 12 / O 9	•	•
U 14 / O 9	•	•
U 16 / O 9	•	•
U 18 / O 9	•	
U 21 / O 9	•	
U 25 / O 9	•	
U 30 / O 9	•	

U = mm / O = mm

Material	E	EV4A
U 8 / O 11	•	•
U 10 / O 11	•	•
U 12 / O 11	•	•
U 14 / O 11	•	•
U 16 / O 11	•	•
U 18 / O 11	•	
U 21 / O 11	•	
U 25 / O 11	•	
U 30 / O 11	•	

U = mm / O = mm

Available movement zone colours:

G = grey, HB = light beige, PG = pastel grey,

GS = black

Schlüter®-DILEX-EHK

E = stainless steel, EB = brushed stainless steel,

EV4A = stainless steel 1.4404 (V4A)

Length supplied: 2.50 m

Material	E	EB	EV4A
U 7 / O 7	•	•	•
U 9 / O 9	•	•	•
U 11 / O 11	•	•	•
U 16 / O 16			•

U = mm / O = mm

Schlüter®-DILEX-HKS/-EHK

Corners and Connectors

E = stainless steel, EB = brushed stainless steel,

EV4A = stainless steel 1.4404 (V4A)

Material	E	EB	EV4A
External Corner	•	•	•
External Corner 135°	•	•	•
Internal Corner (2 way)	•	•	•
Internal Corner 135°	•	•	•
Internal Corner (3 way)	•	•	•
Connector	•	•	•



Note: The prefabricated internal/external corners and connectors are suitable for use with both profile types.

Text template for tenders:

Supply

_____linear metres of Schlüter®-DILEX-HKS as a cove shaped stainless steel profile with trapezoid perforated anchoring legs for creating flexible floor to wall transitions, with an 11 mm movement zone made of synthetic rubber, to be supplied and professionally installed as part of the tile installation, while observing the manufacturer's instructions.

■ E = stainless steel

■ EV4A = stainless steel 1.4404 (V4A).

Matching accessories such as external corners, internal corners and connectors are

■ to be included in the unit price

■ to be invoiced separately.

Colour: _____

Art.-No.: _____

Material: _____/m

Labour: _____/m

Total: _____/m

Text template for tenders:

Supply

_____linear metres of Schlüter®-DILEX-EHK as a cove shaped stainless steel profile for internal wall corners with a trapezoid perforated anchoring leg, to be supplied and professionally installed, while observing the manufacturer's instructions.

■ E = stainless steel

■ EB = brushed stainless steel

■ EV4A = stainless steel 1.4404 (V4A).

Matching accessories such as external corners, internal corners and connectors are

■ to be included in the unit price

■ to be invoiced separately.

Colour: _____

Art.-No.: _____

Material: _____/m

Labour: _____/m

Total: _____/m