

Schlüter®-SHELF

Shelf solution

For direct and retrofit installation in tile joints

17.1

Product data sheet

Application and function

Schlüter-SHELF is an integrated shelf solution - available in brushed stainless steel or aluminium with high-quality powder coating - in the design options FLORAL, CURVE, PURE, SQUARE and WAVE. It can be used as a storage shelf in all tiled wall areas (e.g., showers, kitchens).

Schlüter-SHELF-E are shelves in three different shapes for installation in corners. The shelves can be directly integrated into the tile assembly during tile installation or retrofitted into the joints of tiled walls, using the 2 mm attachment wings.

The specified corner installation and an application of silicone ensures optimum load transfer.

Schlüter-SHELF-W are rectangular shelves with two trapezoid perforated anchoring legs for adhesive bed installation in wall areas. These are integrated into the tile assembly during tile installation.

The anchoring legs and an application of silicone ensures optimum load transfer.

Schlüter-SHELF-N are rectangular shelves for use in prefabricated Schlüter-KERDI-BOARD-N/-NLT niches.

They can be directly integrated into KERDI-BOARD-N/-NLT niches during tile installation for a precise fit.

Their placement on the tile edges and subsequent application of silicone ensures optimum load transfer.

Material

Schlüter-SHELF is available in the following materials:

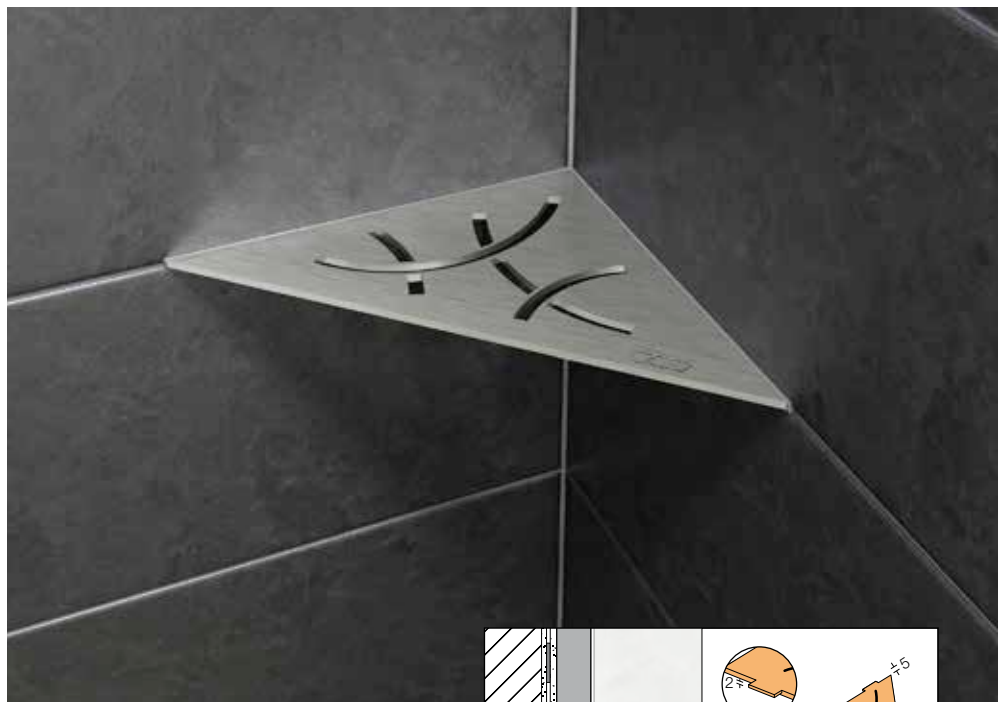

- C/A = MyDesign by Schlüter-Systems
- EB = brushed stainless steel
- V2A, material no. 1.4301 = AISI 304
- TS = textured coated aluminium

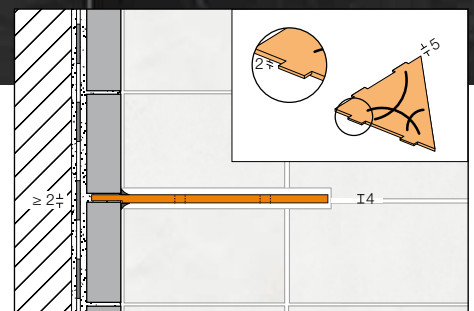

Schlüter®-SHELF-E

Material properties and areas of application:

Schlüter-SHELF is available in a wide variety of materials and finishes. In special cases, the suitability of the shelf must be verified, based on the anticipated chemical or mechanical stresses. The information provided below is intended as a general guideline.



Schlüter-SHELF-EB is made of brushed stainless steel V2A (material no. 1.4301 = AISI 304). Stainless steel is particularly well suited for applications that, in addition to heavy mechanical stresses, require resistance to chemicals such as acidic or alkaline media and detergents. Even stainless steel is not resistant to all chemical stresses, and may be affected by, e.g., hydrochloric and hydrofluoric acid or certain chloride and brine concentrations. In certain cases, that also applies to seawater pools. Special anticipated stresses should therefore be verified in advance.

Schlüter-SHELF-E/ SHELF-W/ SHELF-N AC (colour coated aluminium): The aluminium is suitably pre-treated and then powder-coated with a polyurethane covering. The coating is colour-stable, as well as UV- and weather-resistant. Visible edges should be protected against abrasion.

SHELF-TS (textured coated aluminium) features surfaces with a natural appearance. The aluminium is suitably pre-treated and then powder-coated with a polyurethane covering. The colour-stable coating is UV and weather-resistant. Visible edges should be protected against abrasion.

Installation

Schlüter®-SHELF-E

Corner – direct integration as part of tile installation

1. Install the tile covering with a joint width of ≥ 2 mm.
2. Once the tile adhesive has set, position SHELF-E and mark the tile, moving about 1 cm from the outside edge of the shelf toward the inside. Remove the shelf during grout application to protect it against staining. Leave the joints in the marked area open.
3. Once the grout material has set, the shelf can be put in its final position.
4. Apply a silicone bead around it on all sides.
5. Observe the curing time of the silicone bead before using the shelf.

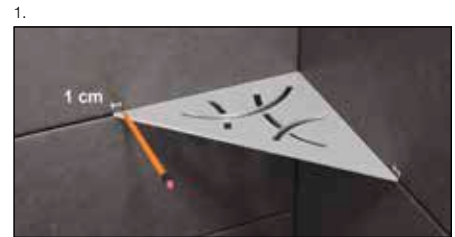

As part of the MyDesign by Schlüter-Systems* series, Schlüter-SHELF-AC can be ordered with a coating in 190 colours of the RAL Classic chart (see Schlüter-SHELF-E/ SHELF-W/ SHELF-N AC for further properties).

* The product advisors of our sales service and our Technical Department will be pleased to assist you with any questions you may have about MyDesign by Schlüter-Systems.

Corner - retrofit installation

1. Determine the joint where SHELF-E is to be placed.
2. Now mark the areas where no grout will be applied to accommodate the attachment wings.
3. Grind the tile joint with a suitable tool (grooving tool, angle grinder etc.).
Caution: Watch the depth of the cut to avoid damaging any waterproofing layers installed behind the tiles.
4. Position the shelf and apply a silicone bead around it on all sides.
5. Observe the curing time of the silicone bead before using the shelf.

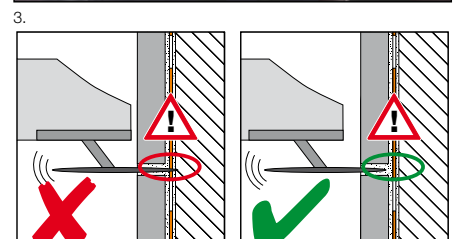

4.

3.

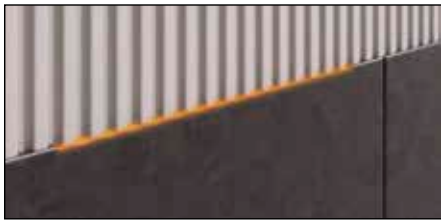

1.



2.



3.



4.

Schlüter®-SHELF-W

Area – integration only feasible as part of tile installation

1. Since the 4 mm material thickness of the shelf is usually larger than the tile joint, the corresponding opening must be created in the coverings in the area of the shelf. To ensure a uniform joint appearance, we recommend creating this opening in the coverings below the shelf.
2. Install the tiles to the height where SHELF-W is to be placed. Insert the 1 mm anchoring leg of the shelf into the adhesive layer of the newly installed tile.
3. Now continue the tile installation in the place where the upper anchoring leg is positioned. It is recommended to support the shelf until the tile adhesive has cured.
4. Once the grout material has set, apply a silicone bead around the shelf on all sides.
5. Observe the curing time of the silicone bead before using the shelf.

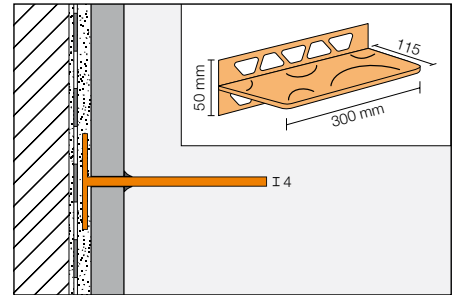

Notes

Schlüter-SHELF requires no special maintenance or care. Do not use abrasive cleaning agents on the sensitive surfaces. Stainless steel surfaces exposed to the environment or aggressive substances should be cleaned periodically using a mild household cleaner. Regular cleaning maintains the neat appearance of stainless steel and reduces the risk of corrosion. All cleaning agents must be free of hydrochloric and hydrofluoric acid. Avoid contact with other metals, such as regular steel, to prevent corrosion. This also includes installation tools such as trowels or steel wool, e.g. for the removal of mortar residue.



1.

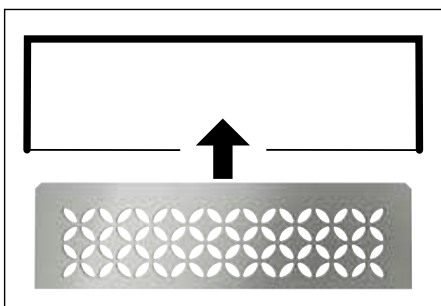

2.

Schlüter®-SHELF-N

Prefabricated niches - Installation in Schlüter-KERDI-BOARD-N/-NLT

1. Install the tiles within the niche to the height where Schlüter-SHELF-N is to be placed.
2. Loosely place SHELF-N on the edge of the tile – with the rounded edges facing back – to replace the joint within the niche. Now continue the tile installation.
3. Once the grout material has set, apply a silicone bead around the shelf on all sides.
4. Observe the curing time of the silicone bead before using the shelf.



3.

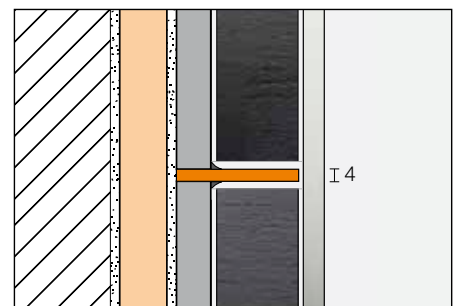



Product overview:

Schlüter®-SHELF-E (for corners)

EB = brushed stainless steel,
TS = textured finished aluminium

SHELF-E	S1	S2	S3
C/A	•	•	•
EB	•	•	•
TSI	•	•	•
TSSG	•	•	•
TSDA	•	•	•
MGS	•	•	•
MBW	•	•	•
TSBG	•	•	•
TSC	•	•	•
TSOB	•	•	•

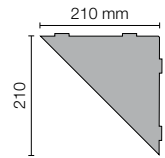

SHELF-E-S1

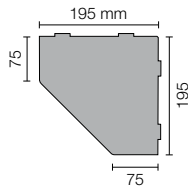

SHELF-E-S2

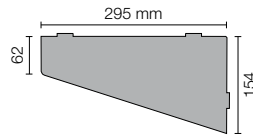

SHELF-E-S3

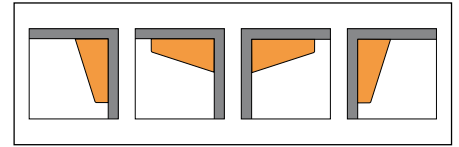

Installation options for Schlüter-SHELF-E-S3



Schlüter®-SHELF-W (for wall areas)

EB = brushed stainless steel,
TS = textured finished aluminium

SHELF-W	S1
C/A	•
EB	•
TSI	•
TSSG	•
TSDA	•
MGS	•
MBW	•
TSBG	•
TSC	•
TSOB	•

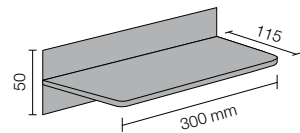

SHELF-W

Schlüter®-SHELF-N (for niches)

EB = brushed stainless steel,
TS = textured finished aluminium

SHELF-N	S1
C/A	•
EB	•
TSI	•
TSSG	•
TSDA	•
MGS	•
MBW	•
TSBG	•
TSC	•
TSOB	•

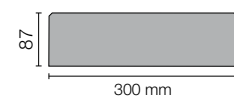

SHELF-N



Colour variants:

Colours:

- C/A = MyDesign by Schlüter-Systems*
- TSI = aluminium, textured natural ivory
- TSSG = aluminium, textured natural stone grey
- TSDA = textured natural dark anthracite
- MGS = matte graphite black
- MBW = matte brilliant white
- TSBG = aluminium, textured natural beige grey
- TSC = aluminium, textured natural cream
- TSOB = textured natural bronze

* RAL colour coating

Design variants:



Design PURE (D7)



Design SQUARE (D3)



Design WAVE (D10)



Design FLORAL (D5)



Design CURVE (D6)

Text template for tenders:

_____units Schlüter-SHELF-E as a wall storage shelf for the corner area to be integrated during tile installation or for retrofit installation in the joints of an existing tiled surface

Material:

- C/A = MyDesign by Schlüter-Systems
- EB = brushed stainless steel (V2A)
- TS = textured finished aluminium

Design:

- FLORAL (D5)
- CURVE (D6)
- PURE (D7)
- SQUARE (D3)
- WAVE (D10)

Shape:

- S1
- S2
- S3

...to be supplied and professionally installed.

Art. no. _____

Material: _____/unit

Labour: _____/unit

Total: _____/unit

_____units Schlüter-SHELF-W as a rectangular shelf with trapezoid perforated anchoring legs on two sides for installation in the wall area. It is to be integrated into the tile assembly during tile installation.

Material:

- C/A = MyDesign by Schlüter-Systems
- EB = brushed stainless steel (V2A)
- TS = textured finished aluminium

Design:

- FLORAL (D5)
- CURVE (D6)
- PURE (D7)
- SQUARE (D3)
- WAVE (D10)

...to be supplied and professionally installed

Art. no. _____

Material: _____/unit

Labour: _____/unit

Total: _____/unit

Schlüter-SHELF-N as a rectangular shelf specifically designed for installation in the prefabricated niches Schlüter-KERDI-BOARD-N/-NLT. It is to be integrated into the tile assembly during tile installation.

Material:

- C/A = MyDesign by Schlüter-Systems
- EB = brushed stainless steel (V2A)
- TS = textured finished aluminium

Design:

- FLORAL (D5)
- CURVE (D6)
- PURE (D7)
- SQUARE (D3)
- WAVE (D10)

...to be supplied and professionally installed.

Art. no. _____

Material: _____/unit

Labour: _____/unit

Total: _____/unit

