

# Schlüter®-KERDI-BOARD

The universal waterproof substrate and structural board

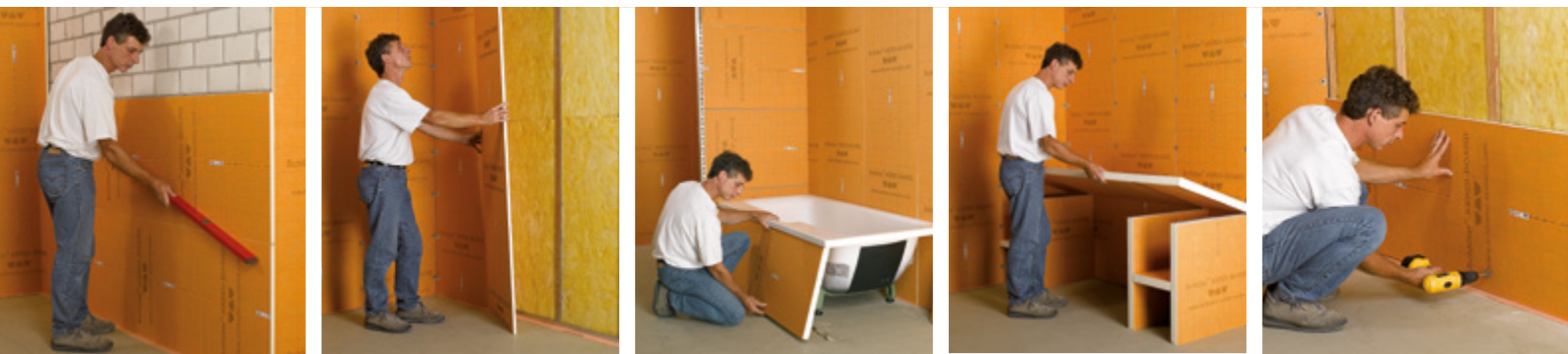

Be creative with substrates!



# Schlüter®-KERDI-BOARD

A comprehensive substrate solution for tile and stone

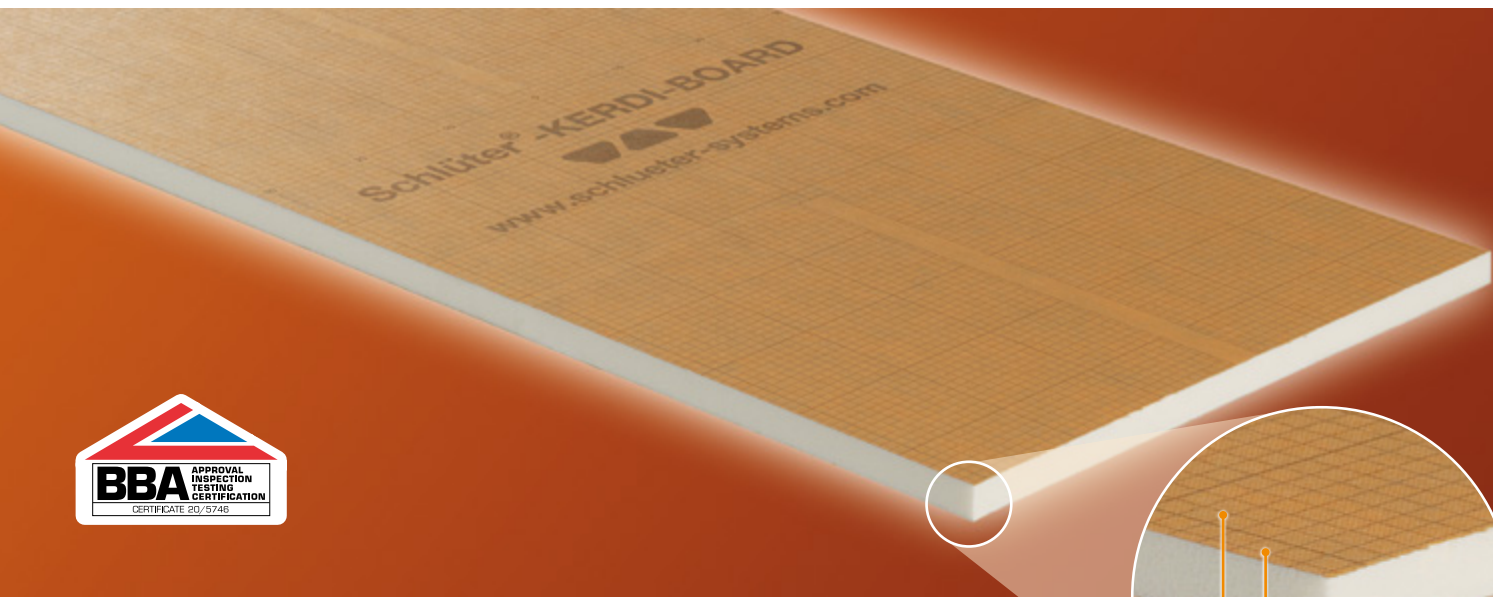

Lightweight, practical, and easy to install - in contrast to conventional structural panels, which can be unwieldy to handle, Schlüter®-KERDI-BOARD makes it easy to create even the most complex structures. That is due to the extensive and sophisticated product range and the intelligent design of the panel.

In addition, Schlüter®-KERDI-BOARD is a backerboard for tile and stone and forms a reliable bonded waterproofing assembly together with our KERDI waterproofing system.

## Benefits:

- ✓ Even, impact resistant and rigid
- ✓ Waterproof and temperature resistant
- ✓ Functional bonded waterproofing assembly
- ✓ Vapour retardant
- ✓ Thermally insulating
- ✓ Fleece webbing for easy anchoring in thin-bed adhesive
- ✓ Quick and easy to install
- ✓ Lightweight, easy to handle and transport

Many substrates encountered in new buildings and renovation projects are unsuitable for tile installation, especially in areas of high moisture. This can require comprehensive additional work and waterproofing measures. Schlüter®-KERDI-BOARD makes it easy to create an instant underlayment for tile installation over substrates as diverse as masonry, stud frame constructions of wood or metal and mixed/existing substrates in renovation projects.

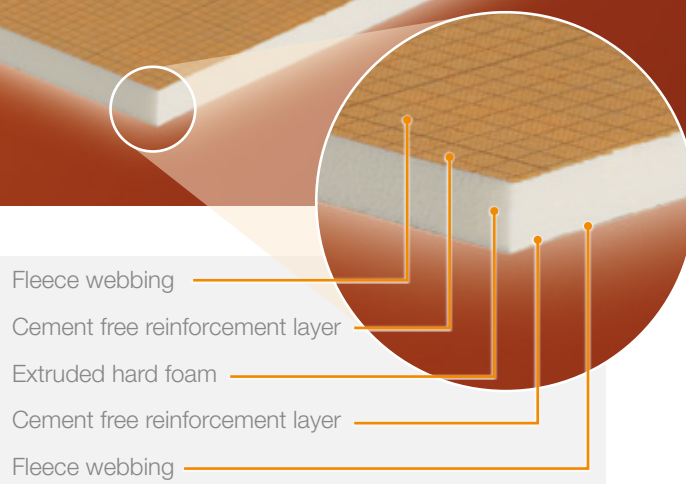
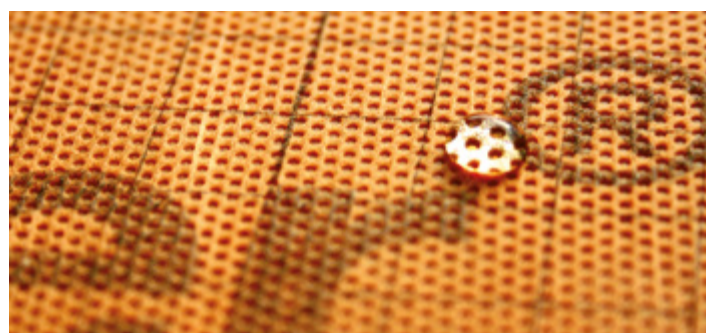

- ✓ Contains no cement or fibreglass
- ✓ Easy to handle
- ✓ Dust free and easy to cut (with a utility knife)
- ✓ Printed grid-lines for precise cutting
- ✓ Suitable for use on any kind of background substrate
- ✓ Suitable for free standing partition walls, shelves, coverings and similar structures
- ✓ Prefabricated niches available

## Technical Information

<b>Thermal conductivity</b>	DIN EN 12667	0.035 W/mK
<b>Temperature resistance</b>		-50 to 75°C
<b>Material density (hard foam)</b>	DIN EN 1602	33 kg/m <sup>3</sup>
<b>Water penetration capacity</b>		0
<b>Water vapour diffusion resistance rating*</b>	DIN EN 12086	
Panel thicknesses 5, 9, 12.5 mm		μ = 1550
Panel thicknesses 19, 28, 38, 50 mm		μ = 440
<b>Linear heat expansion coefficient</b>		0.007 mm/mK
<b>Useable area</b>		
Panel size 125 x 62.5 cm		0.78 m <sup>2</sup>
Panel size 260 x 62.5 cm		1.62 m <sup>2</sup>



A+ level rating of volatile substance emission in indoor air, presenting a very low risk of inhalation toxicity. On a scale ranging from A + (very low emissions) to C (high emissions).

## Ideal tile substrate over green masonry or existing/mixed substrates



To be suitable for the installation of tiles in the thin-bed method with tile adhesive the substrate must be completely level and made of an appropriate, moisture resistant material. However, walls are frequently covered with a gypsum plaster coating as part of the construction. Plaster is not an ideal substrate for tile coverings, especially in high moisture areas.

Additionally, these surfaces are typically not level enough. Other materials such as drywall panels or wood composite are equally unsatisfactory in these areas.



## Ideal tile substrate over timber and metal stud frame structures



Stud frame structures made of wood or metal are typically covered with drywall or wooden panels. However, such materials are typically unsuitable as tile substrates, particularly in areas of high moisture.

Schlüter®-KERDI-BOARD is quick and easy to install as a substrate for tile coverings over stud frame structures of wood or metal, using the screws included in our hardware assortment. The panel joints should be located on the studs; otherwise the abutting panels must be attached with adhesive. Schlüter®-KERDI-BOARD can be installed vertically as well as horizontally.



## Substrate: Board selection and fixing guide

Board Thickness*	5 mm	9 mm	12.5 mm	19 mm	28 mm	38 mm	50 mm	Notes
Walls								
Timber or metal stud frames up to 625 mm centres				✓	✓	✓	✓	Board joints should be supported by noggins.
Timber or metal stud frames up to 400 mm centres			✓	✓	✓	✓	✓	Board joints should be supported by noggins.
Timber or metal stud frames up to 300 mm centres		✓	✓	✓	✓	✓	✓	Board joints should be supported by noggins.
Masonry (Even and Flat)	✓	✓	✓					Boards fixed in solid bed of adhesive using a 6 - 8 mm notched trowel.
Masonry (Uneven)		✓	✓	✓	✓	✓	✓	Boards* dot and dab fixed using flexible tile adhesive.
Plasterboard (with skim coat), Plasterboard (without skim coat), Plywood	✓	✓	✓					Boards fixed in solid bed of adhesive using a 6 - 8 mm notched trowel. Additional screw and washer fixing is recommended at the appropriate centres.
Render	✓	✓	✓					Boards fixed in solid bed of adhesive using a 6 - 8 mm notched trowel.
Painted brickwork		✓	✓	✓	✓	✓	✓	Boards* dot and dab fixed using flexible tile adhesive. Mechanical anchors should be used at appropriate intervals.
Floors								
Concrete/screed floors (mature and dry)	✓	✓	✓	✓	✓	✓	✓	Boards fixed in solid bed of adhesive using a 6 - 8 mm notched trowel.
Plywood and chipboard flooring (floors must be constructed to be rigid and stable)	✓	✓	✓	✓	✓	✓	✓	Boards fixed in solid bed of adhesive using a 6 - 8 mm notched trowel.
Raised access flooring with plywood overlay	✓	✓	✓	✓	✓	✓	✓	Boards fixed in solid bed of adhesive using a 6 - 8 mm notched trowel.

**Note:** This selection guide is intended for guidance only, individual projects may require alternative board selection and fixing methods.

\*Board thickness should be selected to meet required rigidity - if in doubt, choose a thicker board.

## Partition walls

The construction of sanitary installations frequently requires partition walls to create separate shower or toilet cubicles or to divide rooms. Constructing such walls of masonry or covered stud frames is time consuming and surfaces often need further preparation before they are ready for tiling.

Suitable panel thicknesses of Schlüter®-KERDI-BOARD can be used to quickly and simply create stable and self supporting partition walls that are immediately ready for tiling.

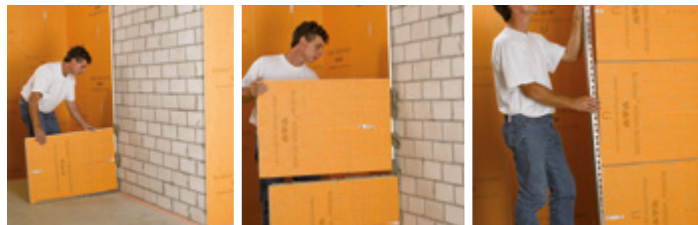

## Bathtubs and shower tray surrounds

In bathroom construction, contractors are frequently expected to prepare the surroundings of bathtubs and shower trays with a suitable substrate for tiling. It is time consuming to create such areas with masonry or timber framework. Schlüter®-KERDI-BOARD can be used to quickly and simply create surrounds for bathtubs that are immediately ready for tiling.

The grooved versions of the panel and the easy cutting properties of Schlüter®-KERDI-BOARD-V also allow for effective use in curved panelling.

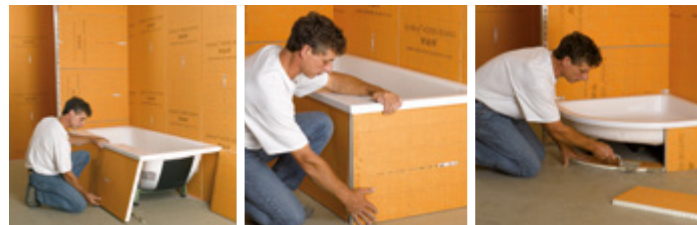

## Pipe covering

The innovative, prefabricated angle of the Schlüter®-KERDI-BOARD-U an -E range, make it easy and simple to conceal pipework.

The components are shipped in a space-saving flat design, which makes them easy to store, and are quick to cut to the necessary dimensions.



## Curved wall areas, columns and fixtures

The grooved version of the Schlüter®-KERDI-BOARD-V panel is designed for creating rounded and curved structures and surfaces.

The panel forms quick and easy to assemble substrates for the creative design of partition walls, tub surrounds, pipe surrounds etc.



## Prefabricated niches

Schlüter®-KERDI-BOARD-N elements can be used to create niches that are flush with the wall.

The prefabricated niche elements are ready for immediate installation and can be installed as a bonded waterproofing assembly and then sealed with the included collar using Schlüter®-KERDI-COLL-L. The large sizes have a variable centre shelf, which is suitable for tile coverings.

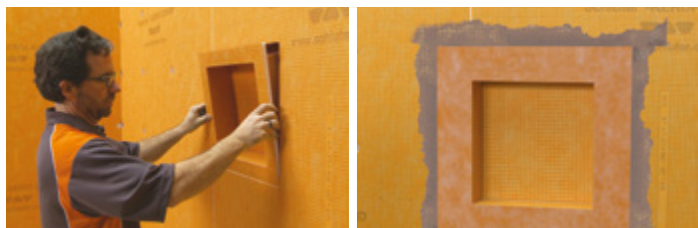

## Vanities and shelving

Schlüter®-KERDI-BOARD is the ideal substrate for constructing vanities and shelving with ceramic tile or natural stone coverings. With the easy cutting properties of Schlüter®-KERDI-BOARD may be cut with a utility knife, makes the material and the required openings easy to cut to size. The waterproof material allows for individual and creative surface design.



## Features: Board selection and fixing guide

Board Thickness*	5mm	9mm	12.5mm	19mm	28mm	38mm	50mm	Notes
Fixtures and Features								
Partition walls						✓	✓	Use the appropriate hardware from the Schlüter®-KERDI-BOARD accessory range.
Shelving				✓	✓	✓	✓	Select the panel thickness depending on the individual application.
Bathtub and shower tray surrounds				✓	✓	✓	✓	Select the panel thickness depending on the individual application.
Vanities and work surfaces					✓	✓	✓	Select the panel thickness depending on the individual application.
Tiling over existing timber or laminate work surfaces	✓	✓						Select adhesive that is compatible with the existing surface and Schlüter®-KERDI-BOARD.
Niches				✓				See Schlüter®-KERDI-BOARD-N for available sizes

**Note:** This selection guide is intended for guidance only, individual projects may require alternative board selection and fixing methods.

\*Board thickness should be selected to meet required rigidity - if in doubt, choose a thicker board.

# Product Overview

## Schlüter®-KERDI-BOARD

Universal substrate, and bonded waterproofing board.

Width = 62.5 cm H = Height/thickness

Length	1.25 m	2.60 m
5 mm = H	•	•
9 mm = H	•	•
12.5 mm = H	•	•
19 mm = H	•	•
28 mm = H	•	•
38 mm = H	•	•
50 mm = H	•	•



## Schlüter®-KERDI-BOARD-N

Prefabricated niches that can be installed with Schlüter®-KERDI and -KERDI-BOARD

Width = 30.5 cm Depth = 8.9 cm Board = 12.5 mm

Height	Shelf
152 mm = H	
305 mm = H	
508 mm = H	•
711 mm = H	•



## Schlüter®-KERDI-BOARD-U

U shaped component to create pipe panelling and boxed sections.

Width = 62.5 cm H = Height/thickness

Segmentation:

21.25 x 20 x 21.25 cm

16.25 x 30 x 16.25 cm

Length	2.60 m
19 mm = H	•

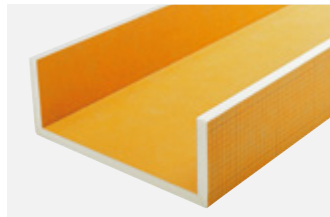

## Schlüter®-KERDI-BOARD-V

Grooved substrate for creating tile coverings with curved installation.

Width = 62.5 cm H = Height/thickness

Length	2.60 m
9 mm = H	•
12.5 mm = H	•
19 mm = H	•
28 mm = H	•
38 mm = H	•
50 mm = H	•

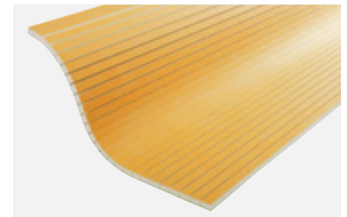

## Schlüter®-KERDI-BOARD-E

Angled component to create corner formations and pipe panelling.

Segmentation: 31.25 x 31.25 cm

Length	2.60 m
12.5 mm = H	•
19 mm = H	•
28 mm = H	•

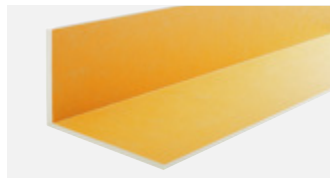

**Note:** Schlüter®-KERDI-BOARD should be stored flat. In case of outdoor storage, protect the material from direct sunlight or weather influences.

## Installation Hardware - see current pricelist for full range

Mechanical anchors for additional attachment of KERDI-BOARD on the substrate.

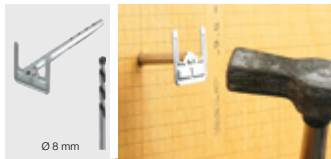

Double sided adhesive tape for connecting KERDI-BOARD panels at abutting joints.



Stainless steel angle profile as an aligned attachment stop for KERDI-BOARD.



Attachment stops can also be created with the 15 cm angle pieces.

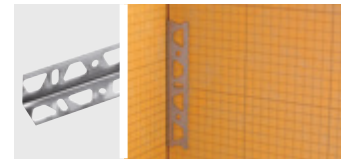

The angle profile can be integrated into the abutting joint or weight bearing joints.



Installation screws for attaching KERDI-BOARD to stud frame structures.

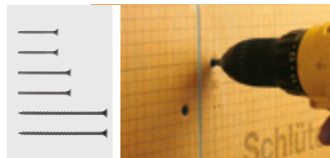

Washers for attaching KERDI-BOARD to stud frame structures.

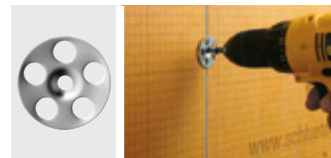

U shaped profile of brushed stainless steel for visible edges of partition walls and shelves.



A plastic profile can be attached behind the U shaped profile for secure attachment.



Perforated U shaped profile of stainless steel to reinforce open ended partition walls.



Perforated U shaped profile can be integrated into the abutting joint of a freestanding walls.



Reinforcement tape for board joints, for use with trowel applied covering materials or plaster

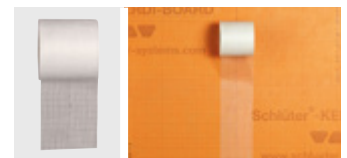

## Schlüter®-KERDI-BOARD in bonded waterproofing assemblies

Schlüter®-KERDI-BOARD is officially approved for use in bonded waterproofing assemblies. For this purpose, the corners and joints must be covered with the sealing band **Schlüter®-KERDI-KEBA**, using the sealing adhesive **Schlüter®-KERDI-COLL-L**. Pipe sleeves or similar features also have to be professionally sealed, e.g. with **Schlüter®-KERDI-KM** pipe collars.



### Schlüter®-KERDI-KEBA

A sealing band to seal mat connections and wall to floor connections.

Length = 5 m and 30 m

Width (mm)	5 m	30 m
85	•	•
125	•	•
150	•	•
185	•	•
250	•	•

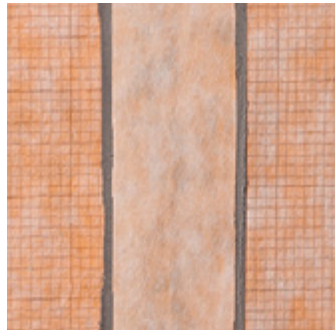

### Schlüter®-KERDI-MV

Pre-fabricated pipe collars for secure waterproofing of pipe penetrations.

Ø mm	diameter pipe (mm)
9	12 - 30
15	22 - 40
21	30 - 60
35	45 - 80
65	75 - 140

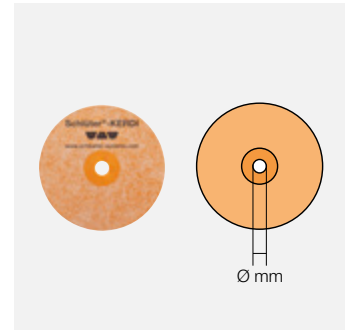

### Schlüter®-KERDI-KERECK

Pre cut sections to produce internal and external corners.

90° external corner, pre cut section	•
90° internal corner, pre cut section	•

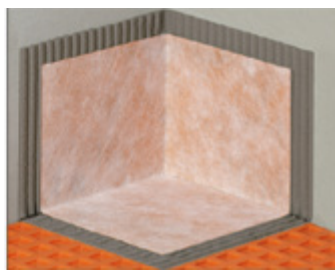
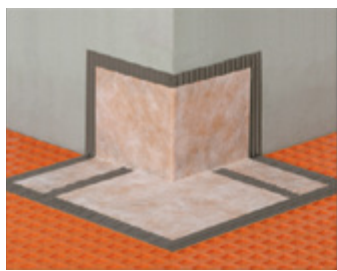

### Schlüter®-KERDI-KERECK-F

Seam sealed prefabricated internal and external corners.

90° external corner, prefabricated	•
90° internal corner, prefabricated	•
135° internal corner, prefabricated	•



### Schlüter®-KERDI-COLL-L

A two component sealant adhesive based on a solvent-free acrylate dispersion and a reactive cementitious powder. It is suitable for adhering and sealing overlaps of Schlüter®-KERDI membranes. In addition, Schlüter®-KERDI-COLL-L can be used to tightly adhere the sealing band Schlüter®-KERDI-KEBA, -FLEX, KERECK and -KM in the creation of bonded waterproofing assemblies.

	Weight (Kg)
two component sealing adhesive	4.25
two component sealing adhesive	1.85



### Schlüter®-KERDI-FIX

An MS polymer based elastic adhesive. It is suited for adjoining profiles and Schlüter®-KERDI-BOARD as well as sealing the abutments and joint areas of Schlüter®-KERDI waterproofing membrane sections. Available in Brilliant White (BW) or Grey (G).

Colour	Volume (ml)
Brilliant white	290
Grey	290

