



Schlüter®-BEKOTEC-THERM

Low height, single room, water-fed underfloor heating for tiled floors*

Schlüter®-BEKOTEC-THERM is an innovative solution for creating heated tiled floors. Our proven system, including innovative studded screed panels, is quickly installed without using costly, construction materials – ceramic tile coverings can typically be installed just one day after a 4:1 sand:cement screed (with NO fibres or reinforcements) has been installed on top of the studded screed panels.

The innovative assembly reduces tensions in the 4:1 sand:cement screed. The advantage for you: NO control joint profiles in the screed, NO buckling, very short construction times. High strength and rapid curing screeds must not be used.

Contact us at bekotec-therm@schluter.co.uk for more information.



The innovative assembly reduces tensions in the screed. The advantage for you: NO control joint profiles in the screed, NO buckling, very short construction times.

Schlüter®-BEKOTEC-THERM EN 12 FK

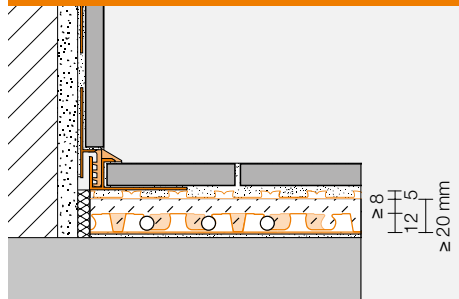

Schlüter®-BEKOTEC-THERM EN 23 F

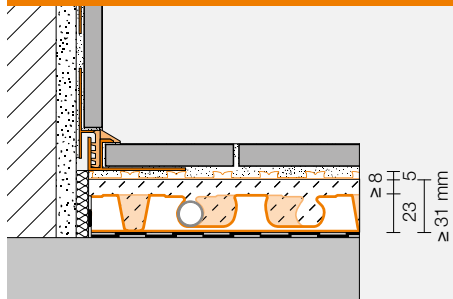

What do I order?

Either Kit 1 or Kit 2 or Kit 3, plus the Mixing Station, plus either the DHERT2 or the DHERT6 thermostat.

* Whilst the system could be used with a non-tiled floor covering (e.g. carpet, vinyl, engineered timber) this application should be discussed with Schlüter's Technical Team before purchasing or installation.

Schlüter®-BEKOTEC-EN FK

Our lightest and thinnest assembly.

- ✓ Studded panel thickness = 12 mm (plus 3 mm tile adhesive)
- ✓ Screed covering = 8 – 15 mm thick
- ✓ Overall assembly height = 20 – 27 mm (plus 3 mm for tile adhesive & 5 mm for DITRA uncoupling membrane)
- ✓ Adhered to substrate with C2/C2F cementitious tile adhesive
- ✓ Weight 40 kg/m²
- ✓ 150 mm pipe spacing
- ✓ Heat output (40°C flow & 20°C return) 80 W/m²

lightweight & low height

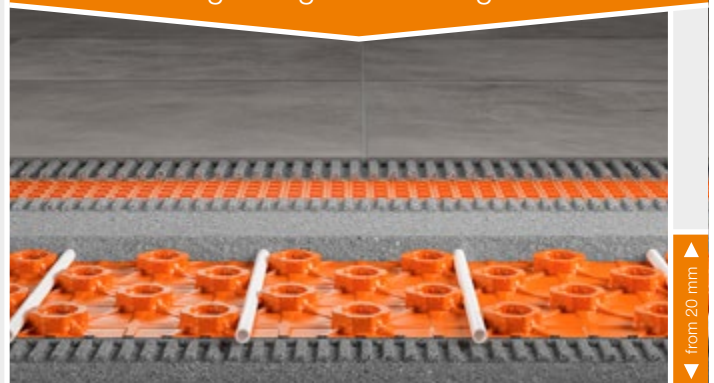

Schlüter®-BEKOTEC-THERM EN 12 FK Kit 1

8 m² underfloor heating kit

Units	Product	Art. No.	GBP £
9	Modular studded screed panels	EN12 FK	371.55
1	Edge insulation strip 25 m roll	BRS808KSF	
1	Levelling panel	EN 12FGK	
1	Pipe clamping strip 10-12 mm	BT ZRKL 1012	
1	Heating pipe 70 m roll (10 mm)	BTHR10RT 70	
2	Heating pipe angle clips	BTZW1014	
1	Connector fitting (2 per bag)	BTZ2AN14	
1	Compression fitting/clamp connection (2 per bag)	BTZ2KV10	

Schlüter®-BEKOTEC-THERM EN 12 FK Kit 2

10 m² underfloor heating kit

Units	Product	Art. No.	GBP £
11	Modular studded screed panels	EN12 FK	510.64
2	Edge insulation strip 25 m roll	BRS808KSF	
2	Levelling panel	EN 12FGK	
1	Pipe clamping strip 10-12 mm	BT ZRKL 1012	
1	Heating pipe 70 m roll (10 mm)	BTHR10RT 70	
4	Heating pipe angle clips	BTZW1014	
1	Connector fitting (2 per bag)	BTZ2AN14	
2	Compression fitting/clamp connection (2 per bag)	BTZ2KV10	
1	Twin connector (2 per bag)	BTZ2DA	

Schlüter®-BEKOTEC-THERM EN 12 FK Kit 3

12 m² underfloor heating kit

Units	Product	Art. No.	GBP £
14	Modular studded screed panels	EN12 FK	638.95
2	Edge insulation strip 25 m roll	BRS808KSF	
2	Levelling panel	EN 12FGK	
1	Pipe clamping strip 10-12 mm	BT ZRKL 1012	
1	Heating pipe 120 m roll (10 mm)	BTHR10RT 120	
4	Heating pipe angle clips	BTZW1014	
1	Connector fitting (2 per bag)	BTZ2AN14	
2	Compression fitting/clamp connection (2 per bag)	BTZ2KV10	
1	Twin connector (2 per bag)	BTZ2DA	

+

Mixing Station

Suitable for 8, 10 & 12 m² underfloor heating kit

Product	Art. No.	GBP £
Single room pack mixing station	UFHC980357	399.00

+

Thermostat

Product	Art. No.	GBP £
Touchscreen thermostat	DHERT2/BW	199.36
Smart voice control thermostat	DHERT6/BW	283.40

EN 12 FK Kits 1, 2 & 3



Mixing Station

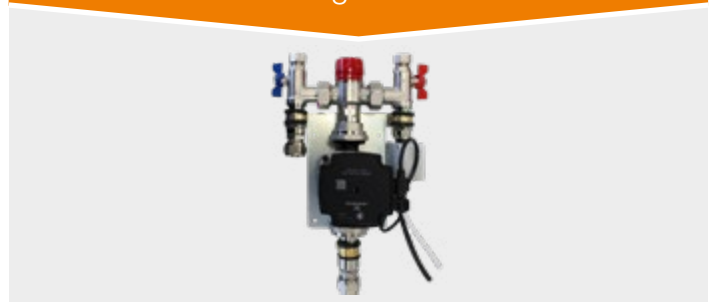

Thermostat



Schlüter®-BEKOTEC-EN F

Universal assembly, with or without sound impact insulation.

- ✓ Studded panel thickness = 23 mm
- ✓ Screed covering = 8 – 25 mm thick
- ✓ Overall assembly height = 31 – 48 mm (plus 5 mm for DITRA uncoupling membrane)
- ✓ Loose lay, can be combined with insulation
- ✓ Weight 57 kg/m²
- ✓ Pipe spacing: 150 mm kits 1 & 2; 225 mm kit 3
- ✓ Heat output: (40°C flow & 20°C return) 90 W/m² kits 1 & 2; 50W/m² kit 3

all-round talent



from 31 mm

Schlüter®-BEKOTEC-THERM EN 23 F Kit 1

10 m² underfloor heating kit

Units	Product	Art. No.	GBP £
11	Modular studded screed panels	EN 23 F	468.02
2	Edge insulation strip 25 m roll	BRS808KSF	
1	Levelling panel	ENFG	
1	Pipe clamping strip 14 - 16 mm	BT ZRKL	
1	Heating pipe 70 m roll (14 mm)	BTHR14RT70	
2	Heating pipe angle clips	BTZW1418	
1	Connector fitting (2 per bag)	BTZ2AN14	
1	Double-sided tape 66 m x 30 mm	BTZDK66	

Schlüter®-BEKOTEC-THERM EN 23 F Kit 2

15 m² underfloor heating kit

Units	Product	Art. No.	GBP £
17	Modular studded screed panels	EN 23 F	732.65
2	Edge insulation strip 25 m roll	BRS808KSF	
2	Levelling panel	ENFG	
1	Pipe clamping strip 14 - 16 mm	BT ZRKL	
1	Heating pipe 120 m roll (14 mm)	BTHR14RT 120	
4	Heating pipe angle clips	BTZW1418	
1	Connector fitting (2 per bag)	BTZ2AN14	
1	Double-sided tape 66 m x 30 mm	BTZDK66	
1	Twin connector (2 per bag)	BTZ2DA	
2	Compression fitting/clamp connection (2 per bag)	BTZ2KV14	

Schlüter®-BEKOTEC-THERM EN 23 F Kit 3

30 m² underfloor heating kit

Units	Product	Art. No.	GBP £
33	Modular studded screed panels	EN 23 F	1008.32
2	Edge insulation strip 25 m roll	BRS808KSF	
3	Levelling panel	ENFG	
4	Pipe clamping strip 14 - 16 mm	BT ZRKL	
2	Heating pipe 70 m roll (14 mm)	BTHR14RT 70	
4	Heating pipe angle clips	BTZW1418	
1	Connector fitting (2 per bag)	BTZ2AN14	
1	Double-sided tape 66 m x 30 mm	BTZDK66	
1	Twin connector (2 per bag)	BTZ2DA	
2	Compression fitting/clamp connection (2 per bag)	BTZ2KV14	

+

Mixing Station

Suitable for 10, 15 & 30 m² underfloor heating kit

Product	Art. No.	GBP £
Single room pack mixing station	UFHC980357	399.00

+

Thermostat

Product	Art. No.	GBP £
Touchscreen thermostat	DHERT2/BW	199.36
Smart voice control thermostat	DHERT6/BW	283.40

EN 23 F Kits 1, 2 & 3

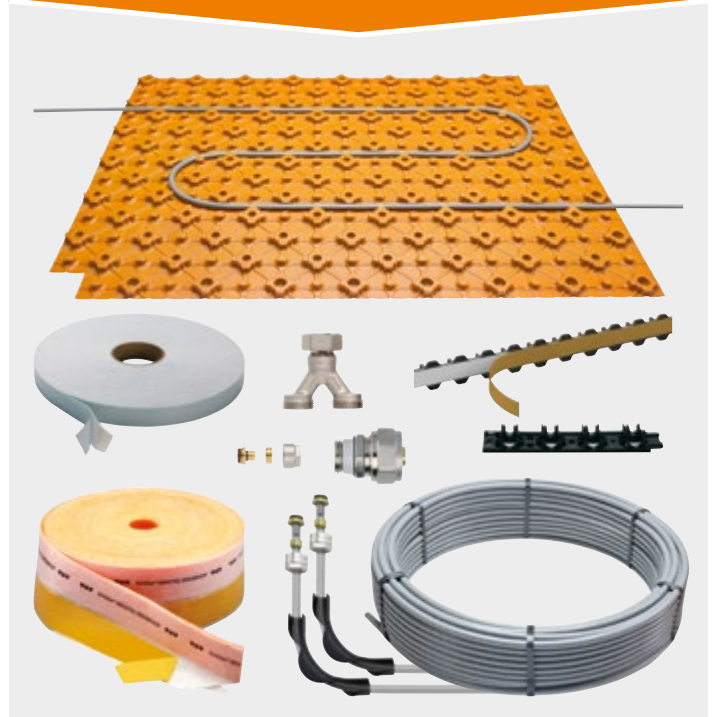

Mixing Station

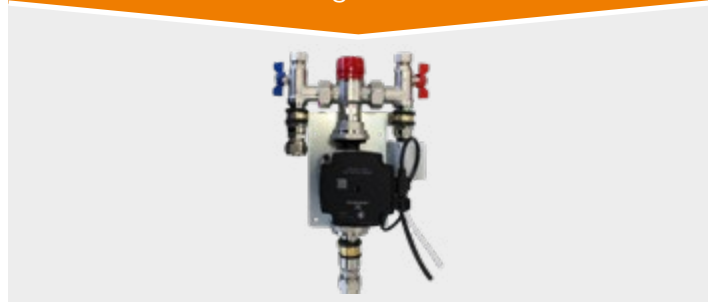

Thermostat



Subject to the General Terms and Conditions of Schlüter-Systems Ltd.
All previous price lists lose their validity on the publication of this price list. Errors, changes, and printing mistakes as well as changes necessary in the interest of product innovation or shipping reserved.
For reasons of printing, colours shown in this price list may differ from actual product colours.

You find the actual "General Terms and Conditions" of Schlüter-Systems Ltd. here:
www.schluter.co.uk/downloads.aspx



Schlüter-Systems KG · Schmölestraße 7 · D-58640 Iserlohn
Tel.: +49 2371 971-261 · Fax: +49 2371 971-112 · info@schlueter.de · www.schlueter-systems.com
Schlüter-Systems Ltd · Units 3-5 Bardon 22 Industrial Estate · Beveridge Lane · Coalville · Leicestershire · LE67 1TE
Tel.: +44 1530 813396 · Fax: +44 1530 813376 · sales@schluter.co.uk · www.schluter.co.uk