

Schlüter®-BARA-RTKE/-RTKEG

Edge profile
with groove for gutter attachment

5.21
Product data sheet

Application and function

Schlüter-BARA-RTKE/-RTKEG are finishing profiles for the exposed edges of covering assemblies on balconies and terraces with finished sloped screeds.

The **Schlüter-BARA-RTKE** profile is especially suited for assemblies with the bonded drainage mat Schlüter-DITRA-DRAIN. The perforated outer edges give the exterior perimeter of tiled areas a neat appearance. The profile also covers the exposed edges of the bonded drainage assembly DITRA-DRAIN below the covering. The cross section of the profile openings is sufficiently large to guarantee drainage and ventilation.

BARA-RTKE is installed in the edge area by adhering the trapezoid perforated anchoring leg with a dry setting thin-bed tile adhesive. To create a bonded waterproofing assembly, attach Schlüter-KERDI with the sealing adhesive Schlüter-KERDI-COLL-L, fully covering the perforated anchoring leg and the bonding flange. If using trowel applied chemical materials for bonded waterproofing, follow the installation instructions of the respective manufacturer.

The **Schlüter-BARA-RTKEG** profile is specifically designed for use with the bonded uncoupling membrane Schlüter-DITRA. The closed outer edges give the exterior perimeter of tiled areas a neat appearance. The front anchoring leg of BARA-RTKE/-RTKEG features a T shaped profile chamber at the bottom edge for attaching the gutter system Schlüter-BARIN.

The elongated openings in the BARIN gutter system allow for sloping the gutter assembly.



Material

The profiles are available in the following material version:

AC = colour coated aluminium
C/A = MyDesign by Schlüter-Systems

Material properties and areas of application:

The coating of the aluminium profiles is colour-stable, as well as UV and weather-resistant. Visible surfaces should be protected against abrasion.

In special cases, the suitability of BARA-RTKE/-RTKEG must be verified based on the anticipated chemical and mechanical stresses.

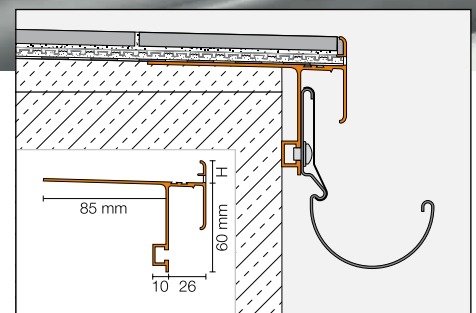



Installation of Schlüter-BARA-RTKE

1. Select BARA-RTKE according to the tile thickness.
2. As an edge finishing and gutter attachment profile (for Schlüter-BARIN), BARA-RTKE is embedded into the thin-bed mortar setting material with the trapezoid perforated anchoring leg aligned at the edge of the screed. Completely cover the anchoring leg with mortar.
3. Adhere KERDI over the entire anchoring leg to the undercut profile of the protruding bonding flange of BARA-RTKE, using the sealing adhesive Schlüter-KERDI-COLL-L or the installation adhesive Schlüter-KERDI-FIX.
4. If using a trowel applied waterproofing compound, integrate BARA-RTKE into the waterproofing system by installing the trapezoid perforated anchoring leg in the exposed edge area. Make sure to continue the waterproofing membrane over the undercut profile of the protruding bonding flange.



Assembly with Schlüter-DITRA-DRAIN 4 and Schlüter-BARA-RTKE



Assembly with Schlüter-DITRA-DRAIN 8 and Schlüter-BARA-RTKE 23

- If using bonded waterproofing systems, observe the installation instructions of the respective manufacturer.
5. Adhere the bonded drainage membrane DITRA-DRAIN on the bonded waterproofing assembly, making sure to continue the membrane to below the joint spacer integrated in the profile. The 23 mm profile height is also suitable for use with Schlüter-DITRA-DRAIN 8. It must be ensured that the drainage space is not fully closed, including during the installation of the covering materials.
 6. The system is now ready for the installation of tiles in the thin-bed method, observing the installation instructions of data sheet 6.2 Schlüter-DITRA-DRAIN. Maintain a proper joint between the tiles and the anchoring leg of BARA-RTKE, to be filled with suitable elastomeric sealing compound.
 7. Once the covering is fully installed, the gutter system can be attached to the Schlüter-BARA profile, using the supplied screws. The elongated openings allow for setting up a slope.
 8. Notes: Pre-fabricated corner pieces are available to create internal and external corners. Abut the profile ends of BARA-RTKE with a joint of approx. 5 mm and conceal the joint with snap-on connectors, using the installation adhesive KERDI-FIX.

The applicable instructions and installation guidelines for the relevant covering assemblies must be observed.

All utilised materials must be weather-resistant, waterproof and suitable for outdoor areas.

Installation of Schlüter-BARA-RTKEG

1. Select BARA-RTKEG according to the tile thickness.
2. As an edge finishing and gutter attachment profile (for Schlüter-BARIN), BARA-RTKEG is embedded into the thin-bed mortar setting material with the trapezoid perforated anchoring leg aligned at the edge of the screed. Completely cover the anchoring leg with mortar.
3. Continue the DITRA membrane to the anchoring leg. Apply the sealing band Schlüter-KERDI-KEBA to create the connection to the profile. The sealing band must be adhered with an overlap of at least 5 mm over DITRA, covering the entire anchoring leg to the undercut profile of the protruding bonding flange of BARA-RTKEG, using the sealing adhesive Schlüter-KERDI-COLL-L or the installation adhesive Schlüter-KERDI-FIX. The system is now ready for the installation of tiles in the thin-bed method, observing the installation instructions of data sheet 6.1 Schlüter-DITRA. Maintain a proper joint between the tiles and the anchoring leg of BARA-RTKEG, to be filled with suitable elastomeric sealing compound.
4. If using a trowel applied waterproofing compound, integrate BARA-RTKEG into the waterproofing system by installing the trapezoid perforated anchoring leg in the exposed edge area. Make sure to continue the waterproofing membrane over the undercut profile of the protruding bonding flange. If using bonded waterproofing systems, observe the installation instructions of the respective manufacturer.
5. Once the covering is fully installed, the gutter system can be attached to the BARA profile, using the supplied screws. The elongated openings allow for setting up a slope.

**Notes:**

Pre-fabricated corner pieces are available to create internal and external corners. About the profile ends of BARA-RTKEG with a joint of approx. 5 mm and conceal the joint with snap-on connectors, using the installation adhesive Schlüter-KERDI-FIX. The applicable instructions and installation guidelines for the relevant covering assemblies must be observed. All utilised materials must be weather-resistant, waterproof and suitable for outdoor areas.

Notes

BARA-RTKE/-RTKEG requires no special maintenance or care. The powder coated surface of the aluminium profile is UV resistant and colour-stable. Damage to surface can be restored with paint.



As part of the MyDesign by Schlüter-Systems* series, Schlüter-BARA-RTKE and -RTKEG can be ordered with a coating in 190 colours of the RAL Classic chart.

*The product advisors of our sales service and our Technical Department will be pleased to assist you with any questions you may have about MyDesign by Schlüter-Systems.

Product overview:**Schlüter®-BARA-RTKE**

Colours: PG = pastel grey, GM = grey metallic, C/A = MyDesign by Schlüter-Systems*
Supplied length: 2.50 m

Colours	PG	GM	C/A
H = 10 mm	•	•	•
H = 15 mm	•	•	•
H = 18 mm	•	•	•
H = 21 mm	•	•	•
H = 23 mm	•	•	•
90° corner	•	•	•
135° corner	•	•	•
Internal corner 90°	•	•	•
Connector	•	•	•

* RAL colour coating

H = 23 mm is also suitable for use with Schlüter-DITRA-DRAIN 8.

Schlüter®-BARA-RTKEG

Colours: PG = pastel grey, GM = grey metallic, C/A = MyDesign by Schlüter-Systems*
Supplied length: 2.50 m

Colours	PG	GM	C/A
H = 4 mm	•	•	•
H = 10 mm	•	•	•
H = 15 mm	•	•	•
H = 18 mm	•	•	•
H = 21 mm	•	•	•
90° corner	•	•	•
135° corner	•	•	•
Internal corner 90°	•	•	•
Connector	•	•	•

* RAL colour coating

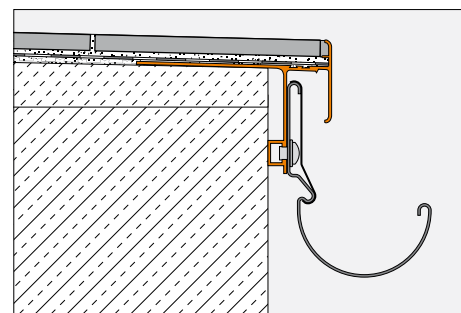

Assembly with Schlüter-DITRA and Schlüter-BARA-RTKEG

**Text template for tenders:**

___ linear metres of Schlüter-BARA-RTKE as an angled balcony edge profile made of coated aluminium with a protruding bonding flange, a perforated edge and an attached drip lip, as well as an attachment option for a height-adjustable gutter, to be supplied and professionally installed in the edge area over a finished sloped screed with the trapezoid perforated anchoring leg while observing the manufacturer's instructions. Accessories such as internal/external corners and connectors

- are to be included in the unit prices
- are to be invoiced separately.

Profile height: _____ mm

Colour: _____

Art.-No.: _____

Material: _____/m

Labour: _____/m

Total: _____/m

Text template for tenders:

___ linear metres of Schlüter-BARA-RTKEG as an angled balcony edge profile made of coated aluminium with a protruding bonding flange, a closed edge and an attached drip lip, as well as an attachment option for a height-adjustable gutter, to be supplied and professionally installed in the edge area over a finished sloped screed with the trapezoid perforated anchoring leg while observing the manufacturer's instructions. Accessories such as internal/external corners and connectors

- are to be included in the unit prices
- are to be invoiced separately.

Profile height: _____ mm

Colour: _____

Art.-No.: _____

Material: _____/m

Labour: _____/m

Total: _____/m